

## A.39 CEILING AND SUSPENSION

design  
C. de Bevilacqua

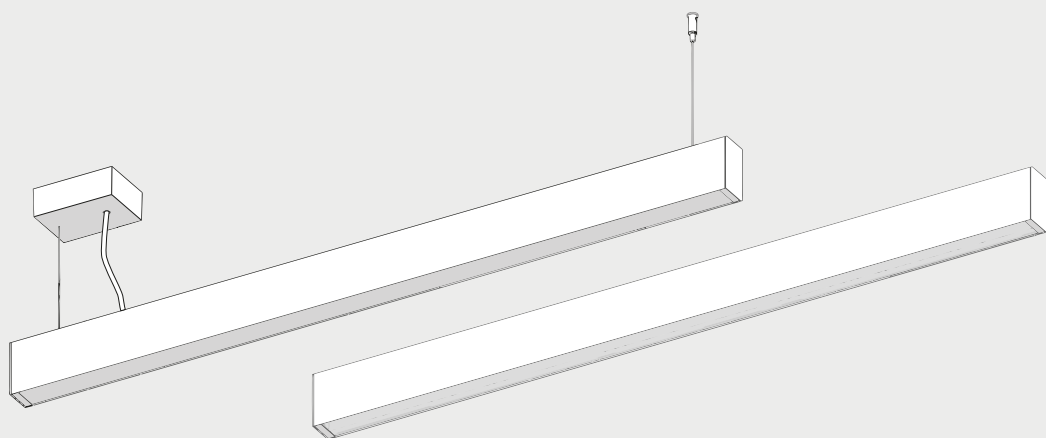



i

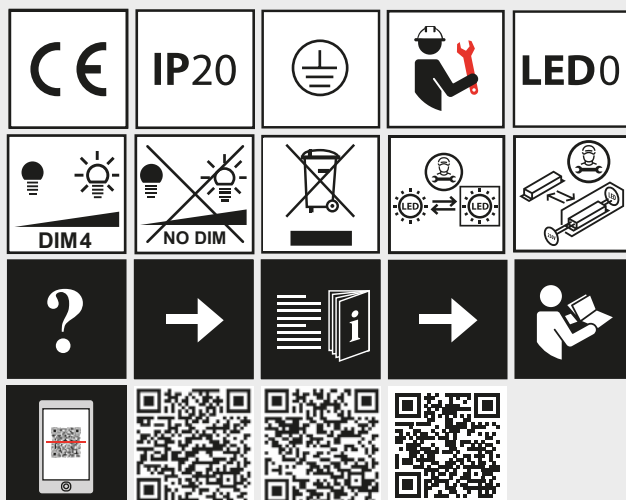

Artemide App  
Starting Guide

## DIFFUSED EMISSION

EMISSION	DIMMING	LENGTH [mm]	POWER [W]	Inrush current [A]	Inrush current time [µsec]	Nr. of power units under same MCB			Nr. of DALI addresses
						B16A	C16A	C20A	
DIRECT	NO DIM	1184	20	14,1	240	20	38	55	-
		1482	25	14,1	240	19	36	53	-
		2368	40	20	240	15	30	42	-
		2960	49	20	240	12	25	36	-
	DALI	1184	20	26	140	20	38	55	1
		1482	25	26	140	19	36	53	1
		2368	40	24,9	215	15	30	42	1
		2960	49	24,9	215	12	25	36	1
DIRECT + INDIRECT	NO DIM	1184	34	14,1	240	17	33	47	-
		1482	45	20	240	13	27	38	-
		2368	70	34,1	240	9	17	23	-
		2960	88	40	280	7	14	19	-
	DALI	1184	34	26	140	17	33	47	1
		1482	45	24,9	215	13	27	38	1
		2368	70	50,9	215	9	17	23	2
		2960	88	49,8	215	7	14	19	2

## CONTROLLED EMISSION

EMISSION	DIMMING	LENGTH [mm]	POWER [W]	Inrush current [A]	Inrush current time [µsec]	Nr. of power units under same MCB			Nr. of DALI addresses
						B16A	C16A	C20A	
DIRECT	NO DIM	1184	34	14,1	240	17	33	47	-
		1482	42	20	240	14	28	40	-
		2368	66	20	240	9	18	25	-
		2960	82	20	240	7	14	20	-
	DALI	1184	34	26	140	17	33	47	1
		1482	42	24,9	215	14	28	40	1
		2368	66	24,9	215	9	18	25	1
		2960	82	24,9	215	7	14	20	1
DIRECT + INDIRECT	NO DIM	1184	57	20	240	10	22	30	-
		1482	73	20	240	8	16	22	-
		2368	116	40	240	5	10	14	-
		2960	149	40	240	2	8	9	-
	DALI	1184	57	24,9	215	10	22	30	1
		1482	73	24,9	215	8	16	22	1
		2368	116	49,8	215	5	10	14	2
		2960	149	49,8	215	2	8	9	2



## A. 39 SUSPENSION

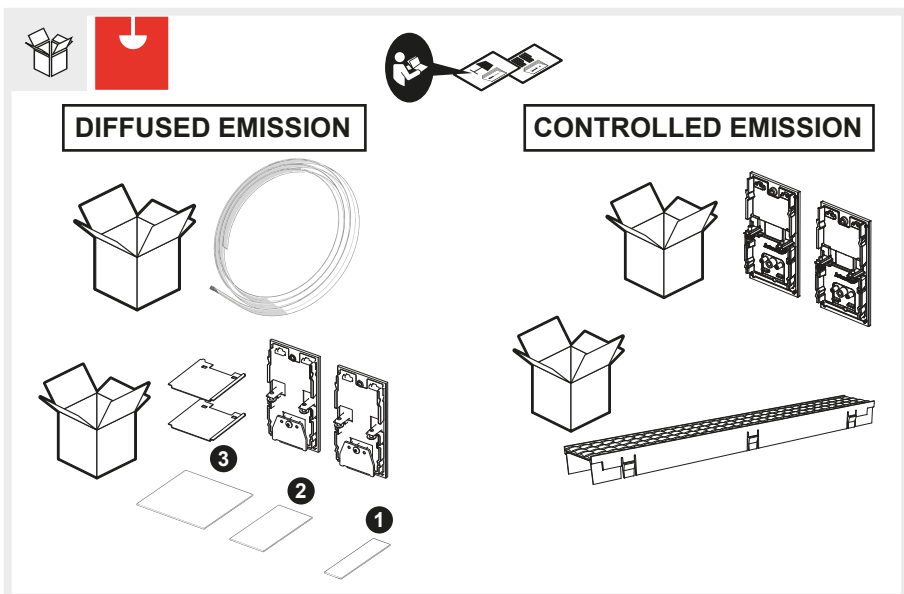
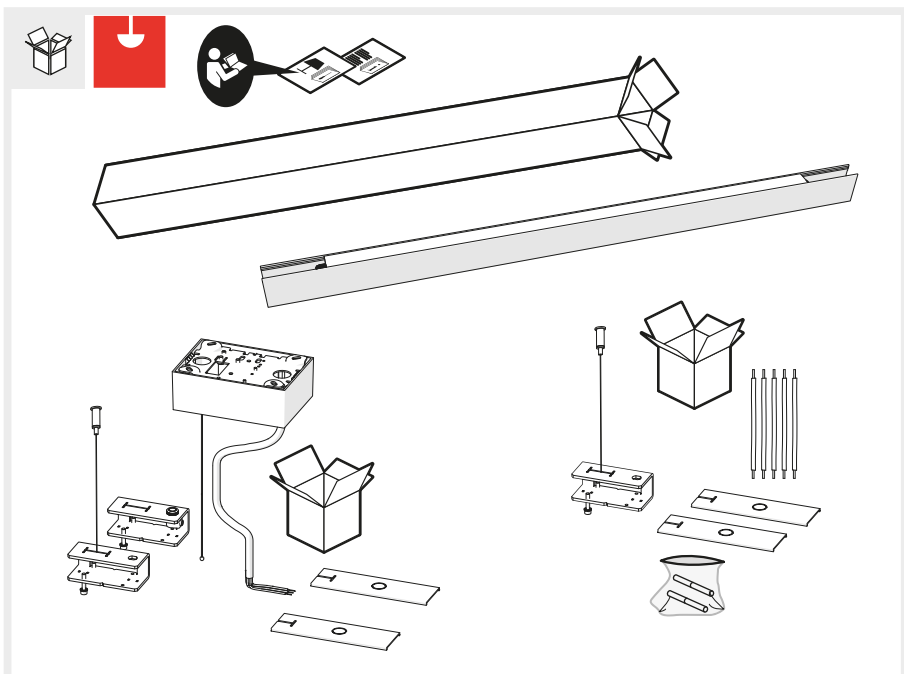



1

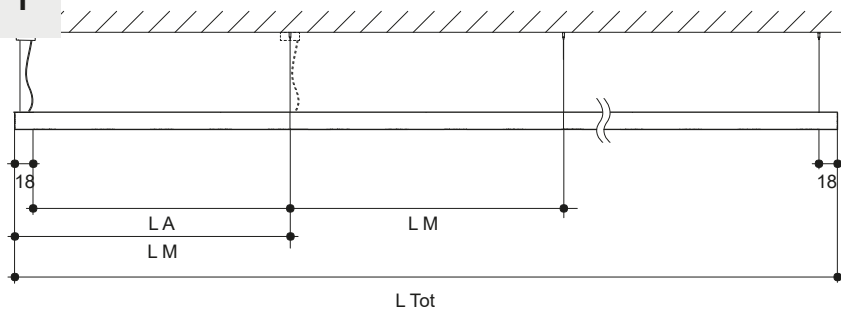

CEILING DRILING LAY-OUT

LM [mm]	LA [mm]	⚖ Kg
1184	LM-18 mm	2,3
1480		2,9
2368		4,4
2960		5,7

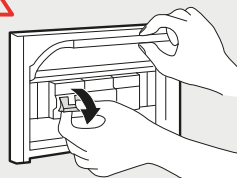

2

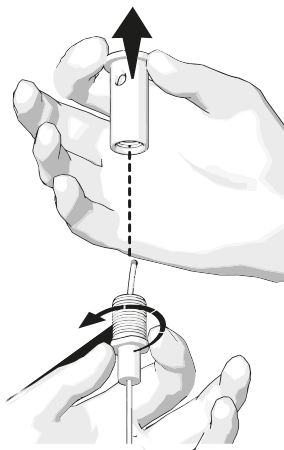

3

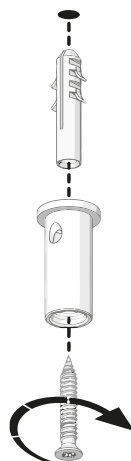

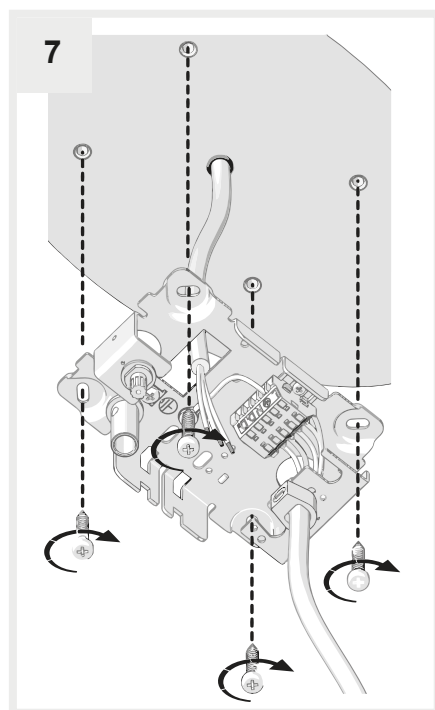
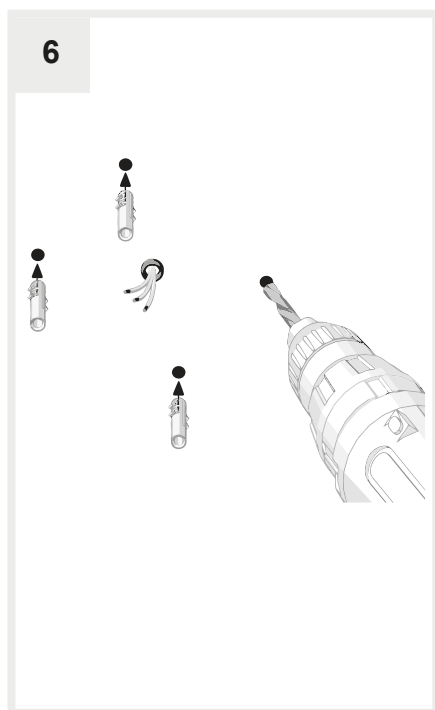
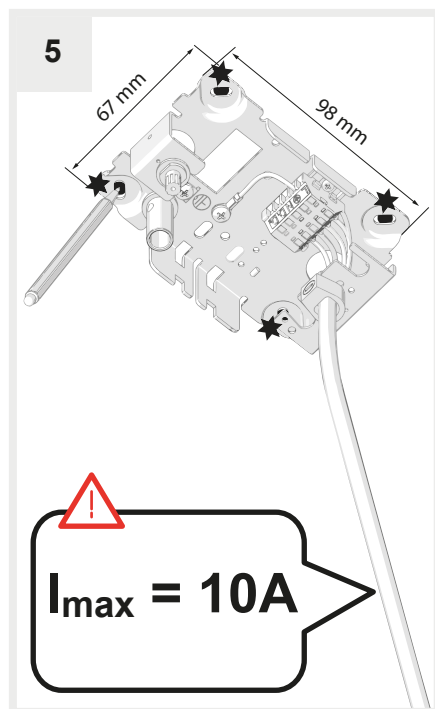
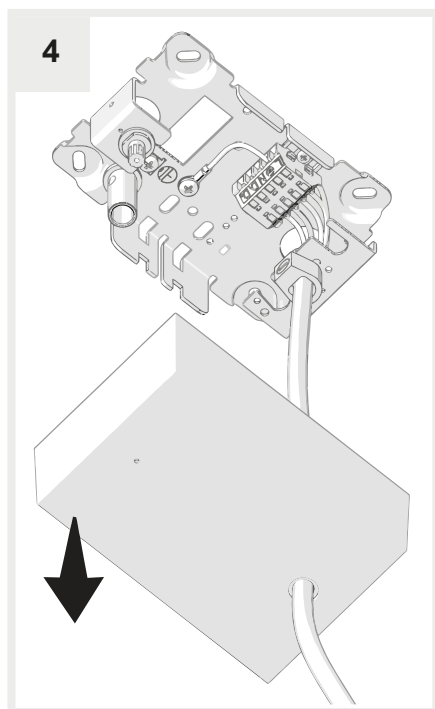

8a

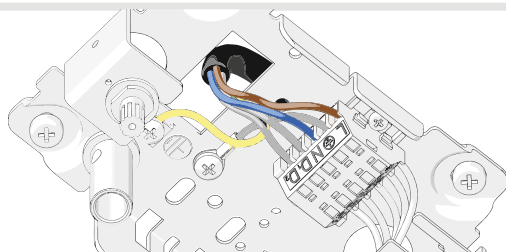

8b

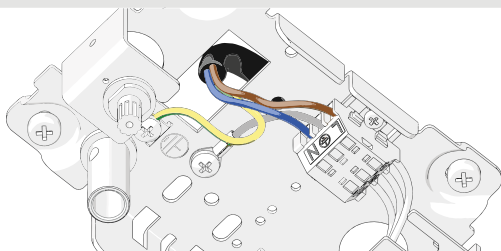

8c

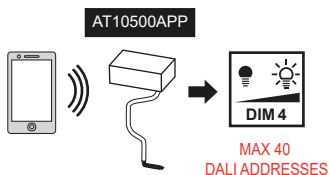
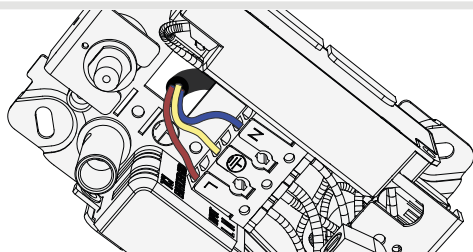

9

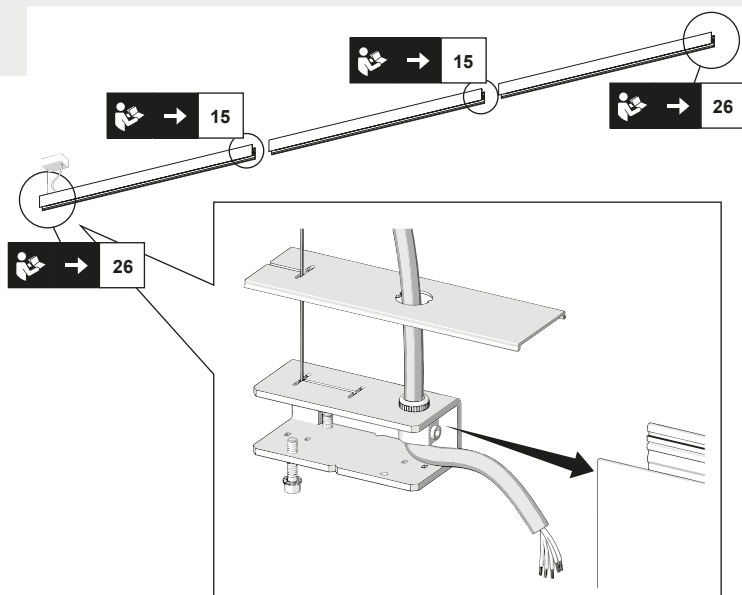

10

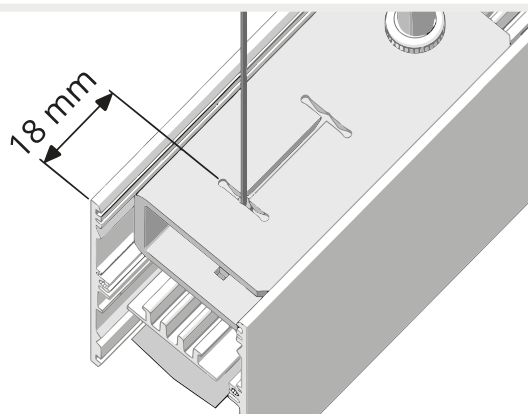

11

**DIFFUSED EMISSION**

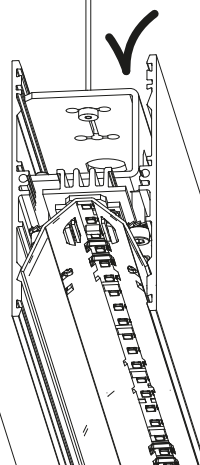
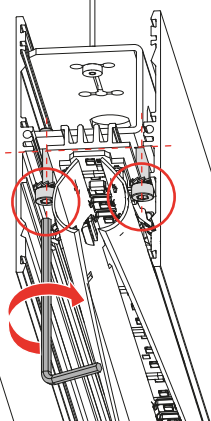
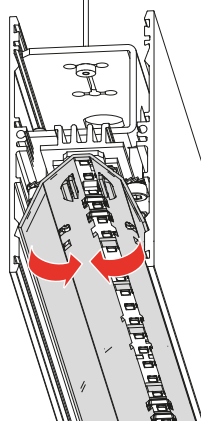

11

**CONTROLLED EMISSION**

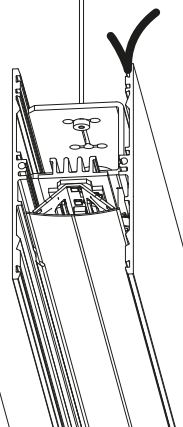
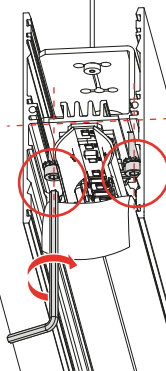
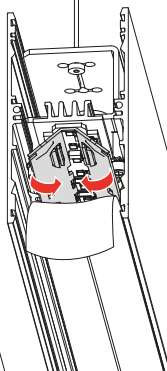
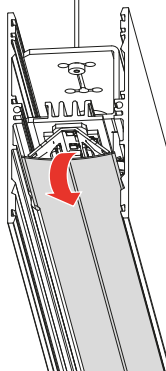

12a

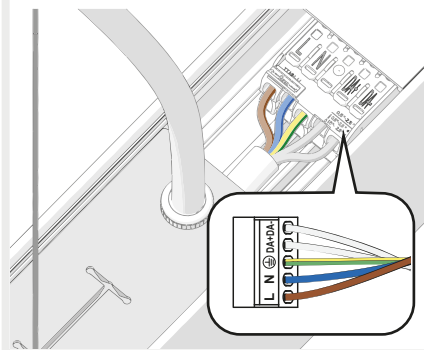
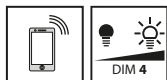

12b

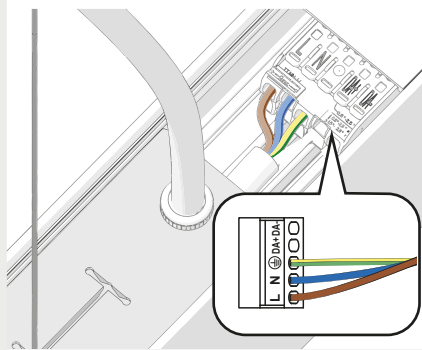

13a

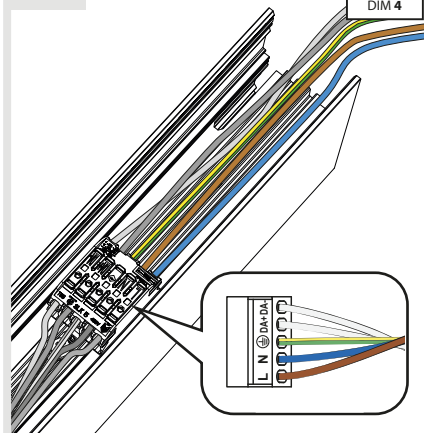

13b

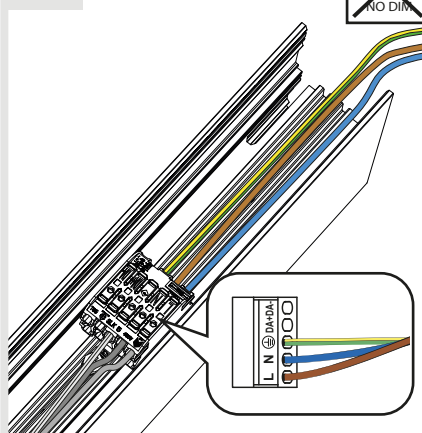

14

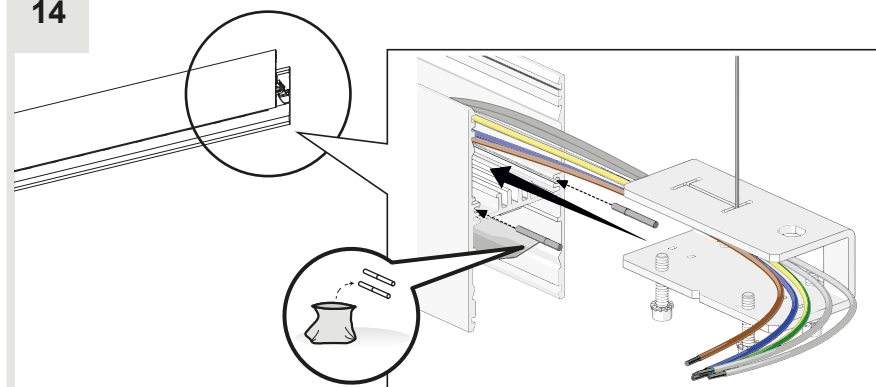

15

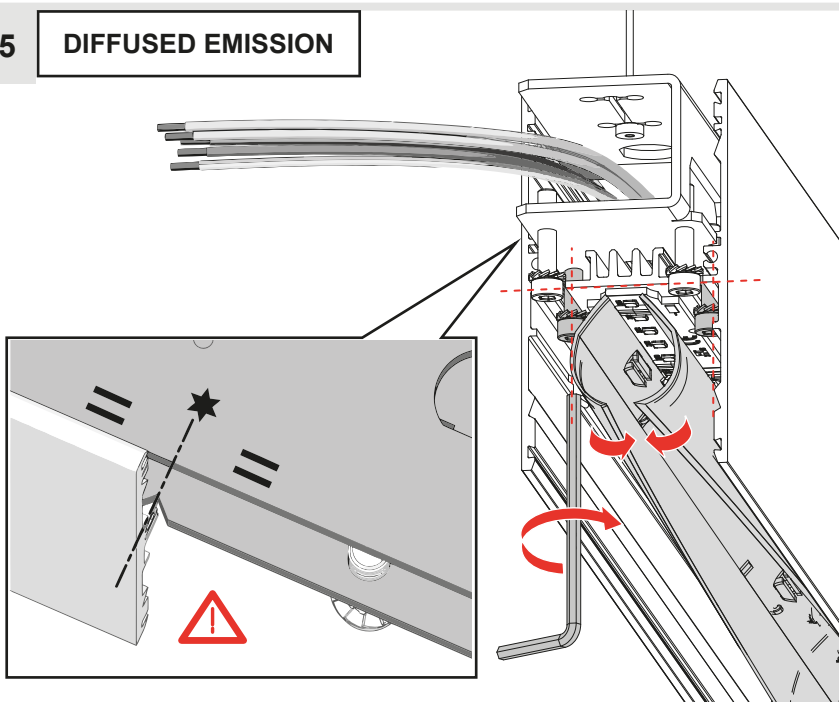
**DIFFUSED EMISSION**

15

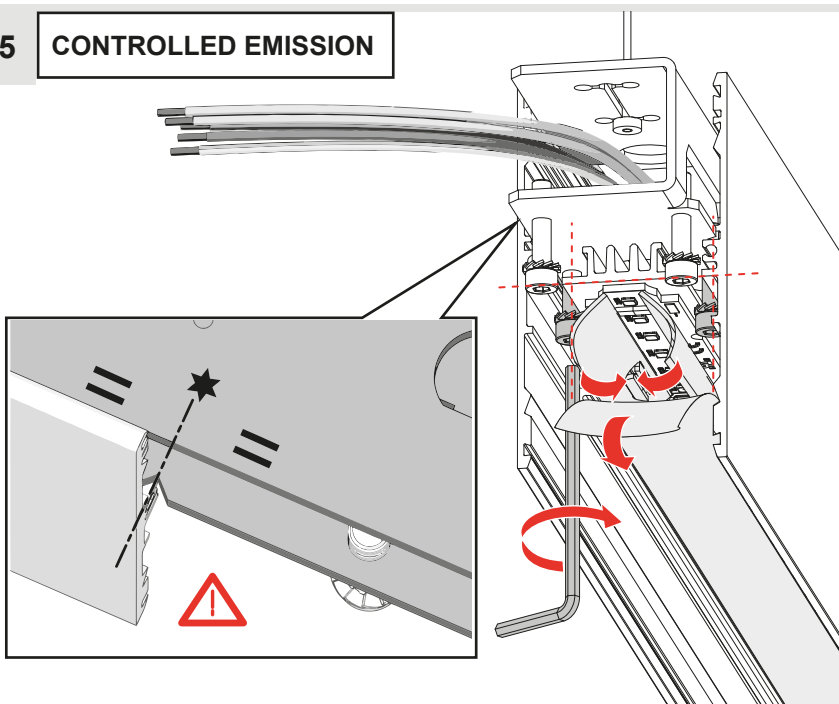
**CONTROLLED EMISSION**

16

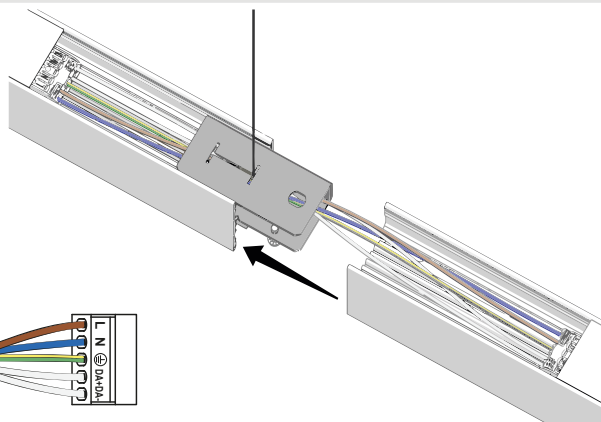
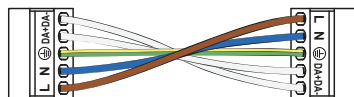

17

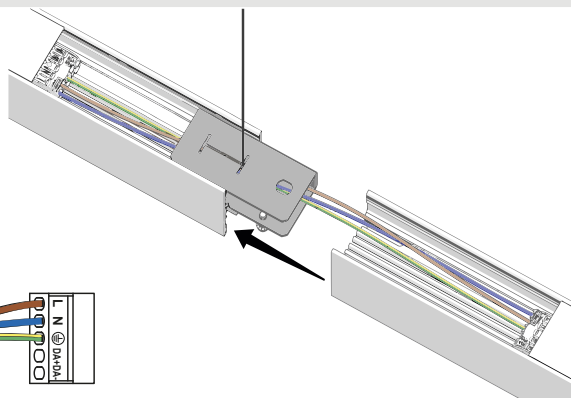
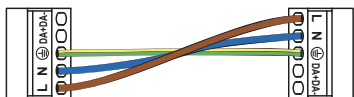

18

DIFFUSED EMISSION

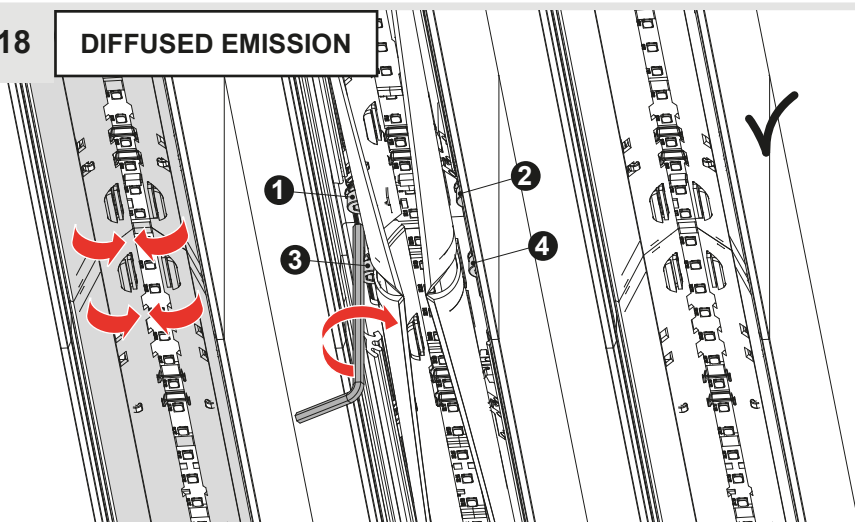

18

# CONTROLLED EMISSION

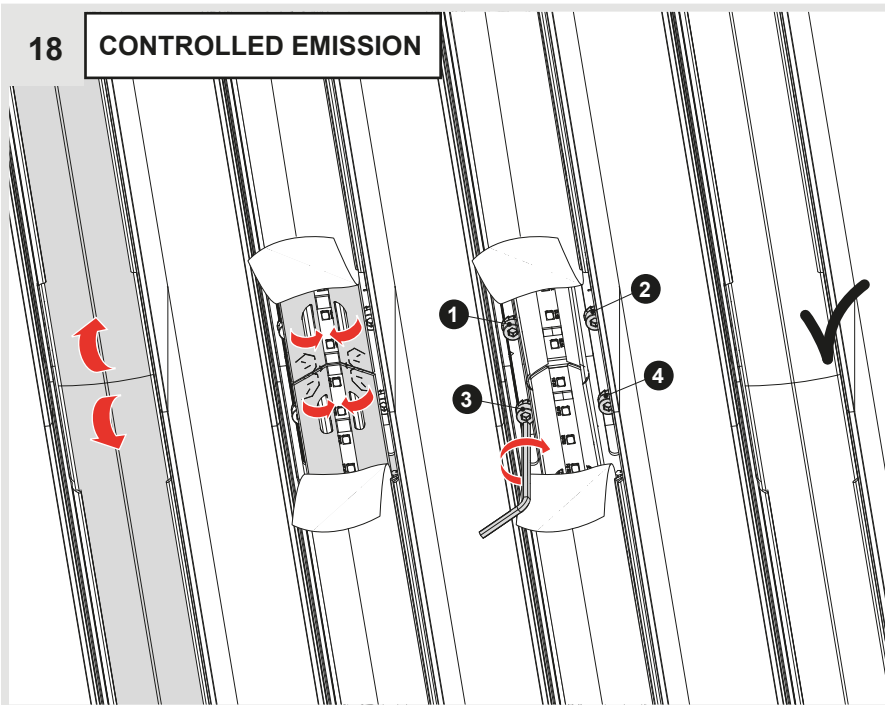

19

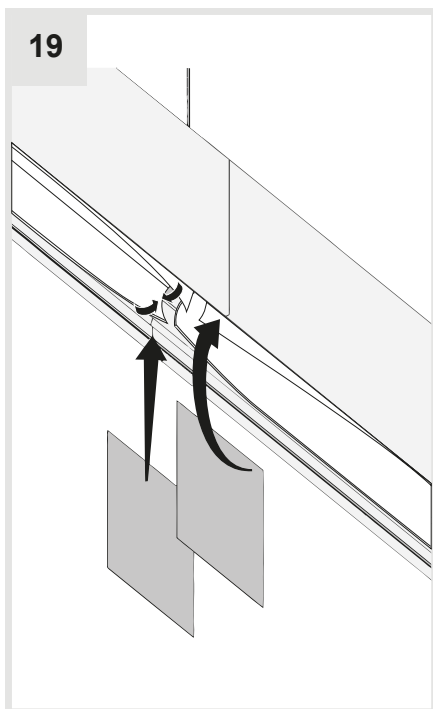

20

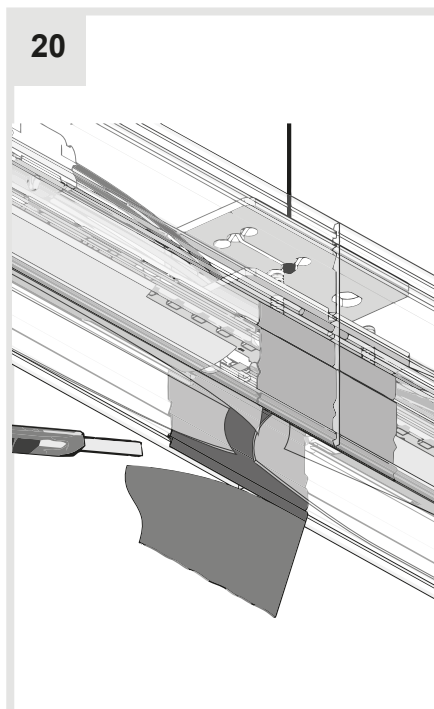



21

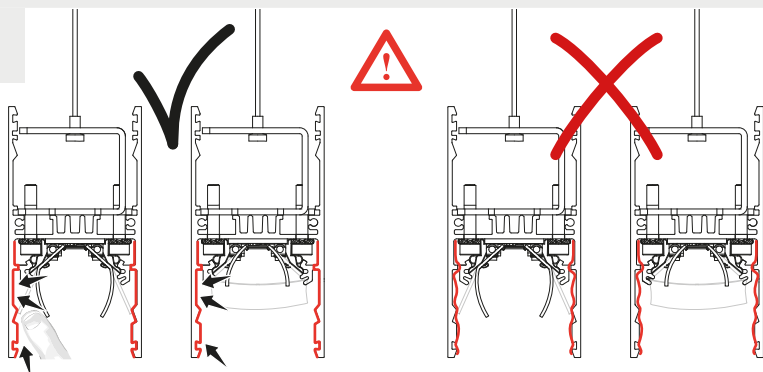

22

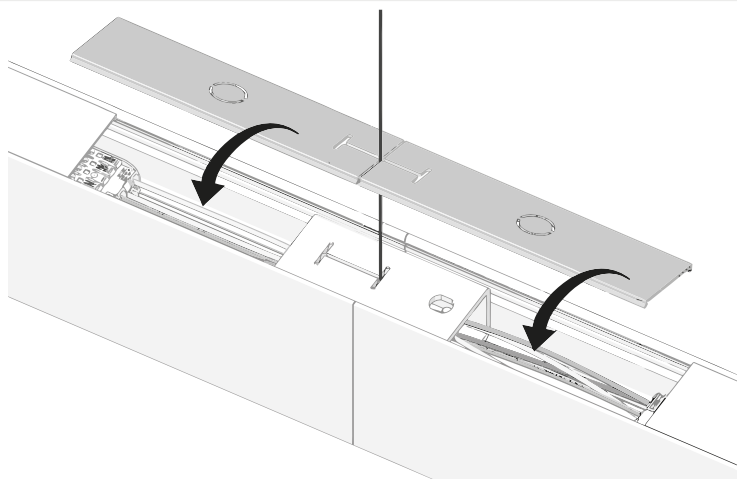

23

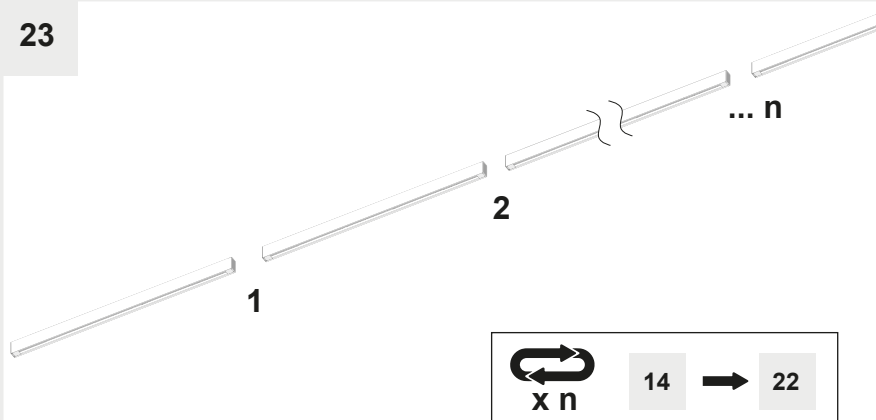

24

**DIFFUSED EMISSION**

L Tot [mm]	Type	L1 [mm]
1.184 ÷ 2.368	1	10
2.368 ÷ 10.000	2	20
10.000 ÷ 30.000	3	40

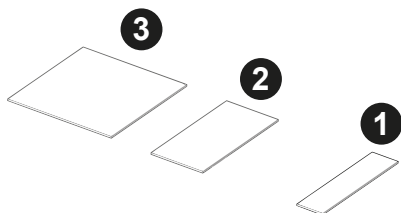
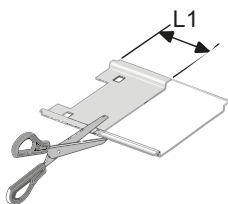
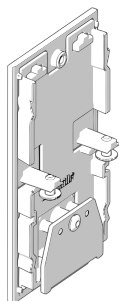

25

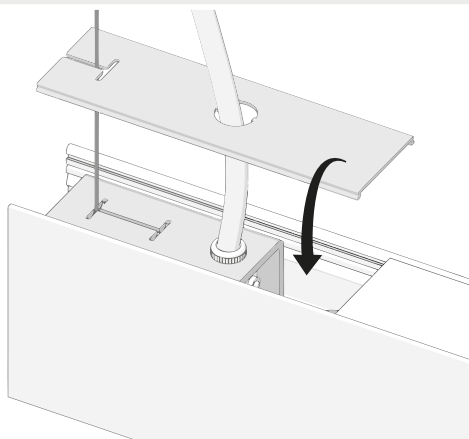
**i****DIFFUSED EMISSION**

26 → 33

**CONTROLLED EMISSION**

34 → 35

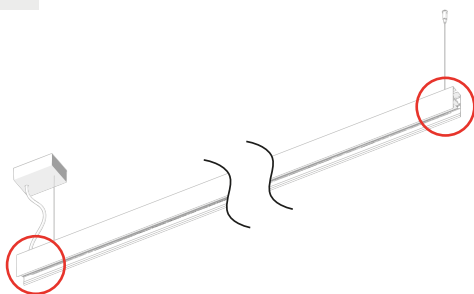

26

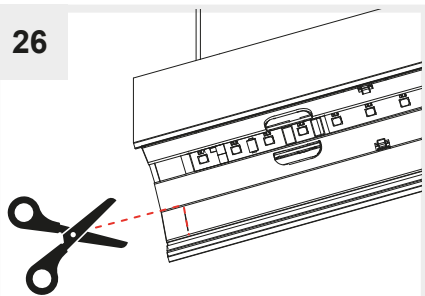

27

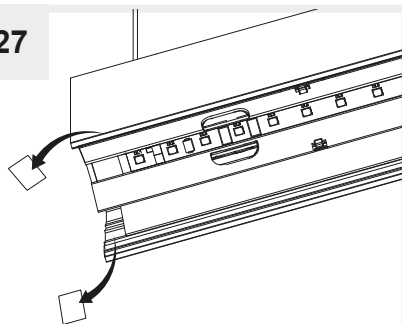

28

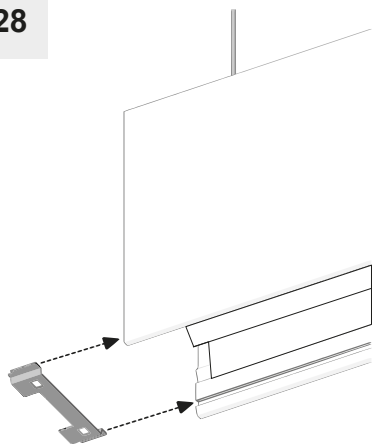

29

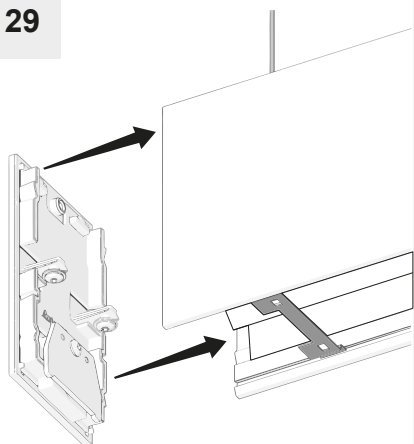

30

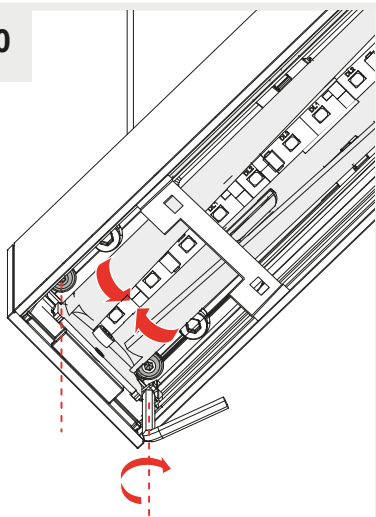



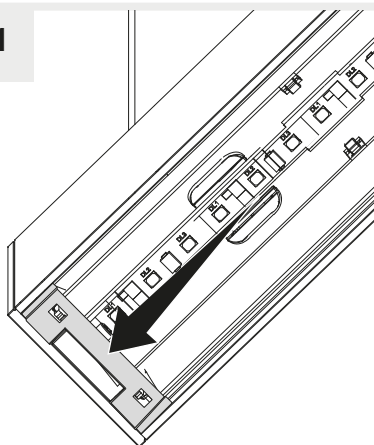



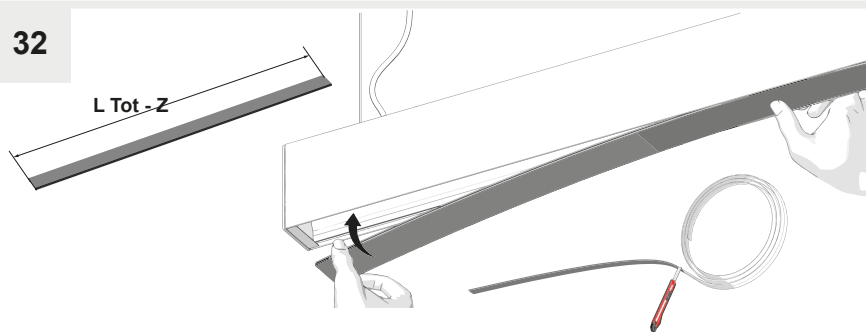

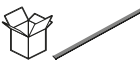
31



32

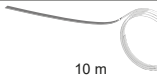

L Tot [mm]			Z [mm]
1184	1184 mm		~7
1480	2368 mm		~7
2368	2368 mm		~7
2960	2960 [mm]		~7
2960 ÷ 10000	 10 m		~15
10001 ÷ 30000			~35

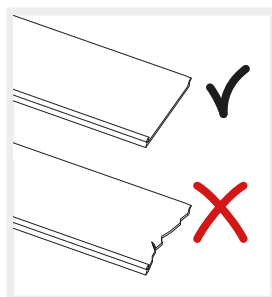
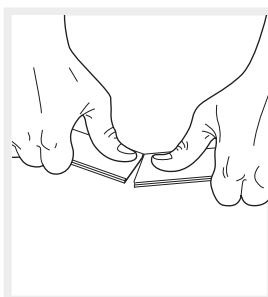
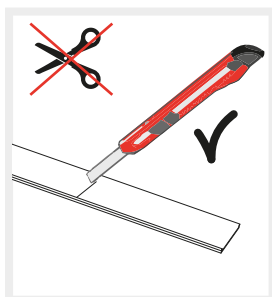

33

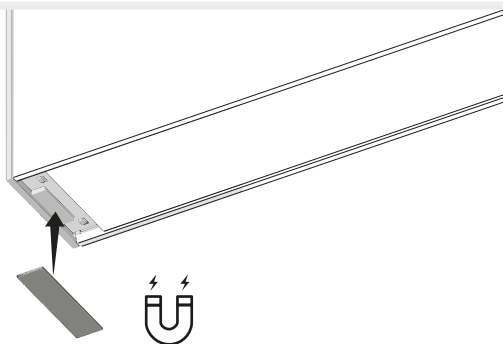

34

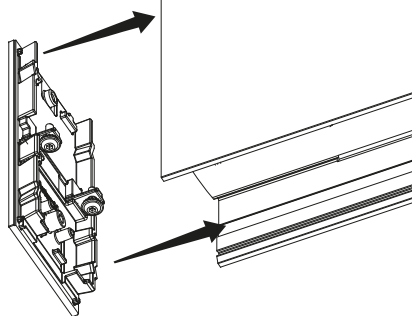

35

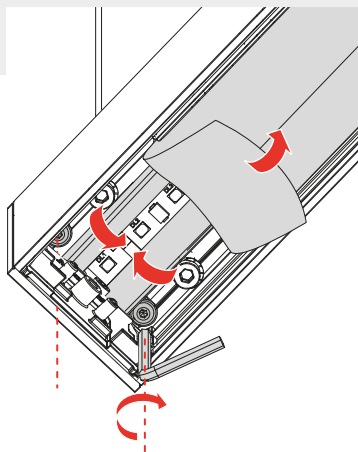

Y503300215



## A. 39 CEILING

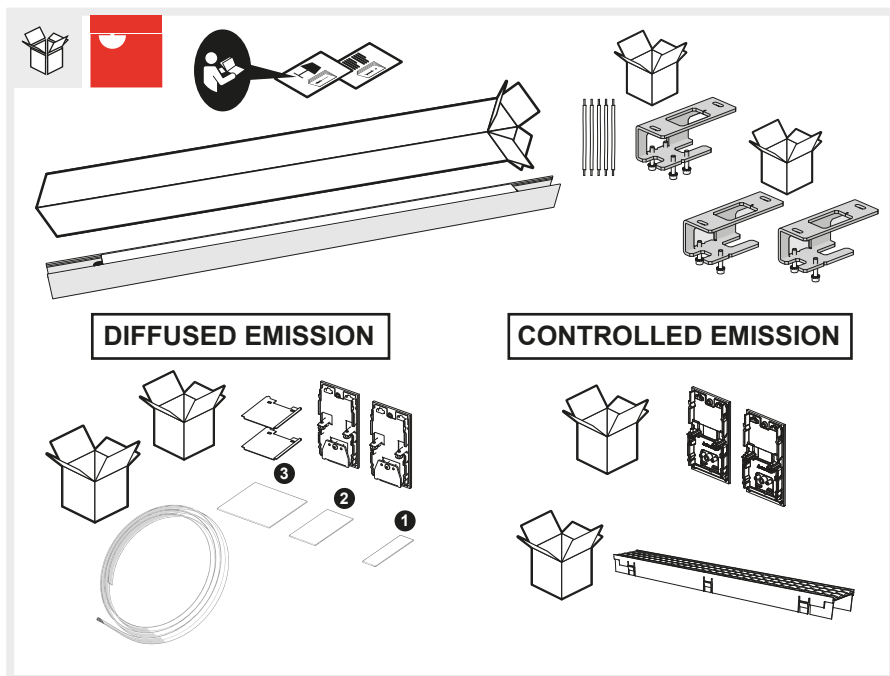

1

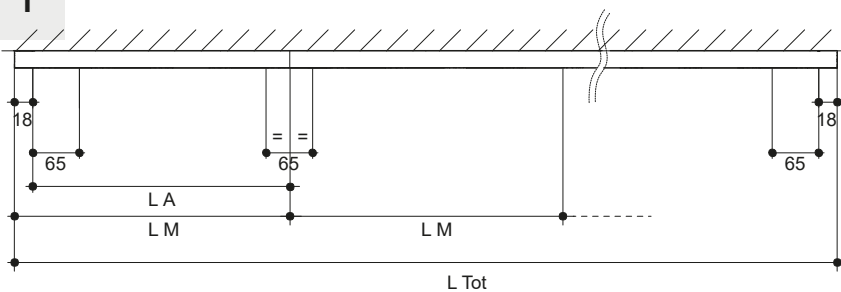

CEILING DRILLING LAY-OUT		
LM [mm]	LA [mm]	⚖ Kg
1184	LM-18 mm	2,3
1480		2,9
2368		4,4
2960		5,7

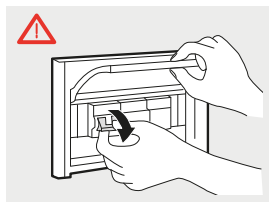

2

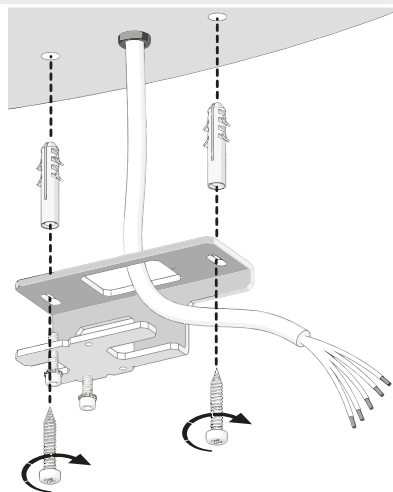

3

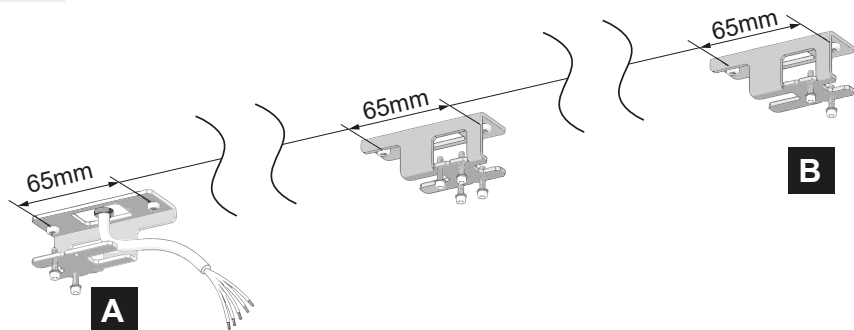

4a

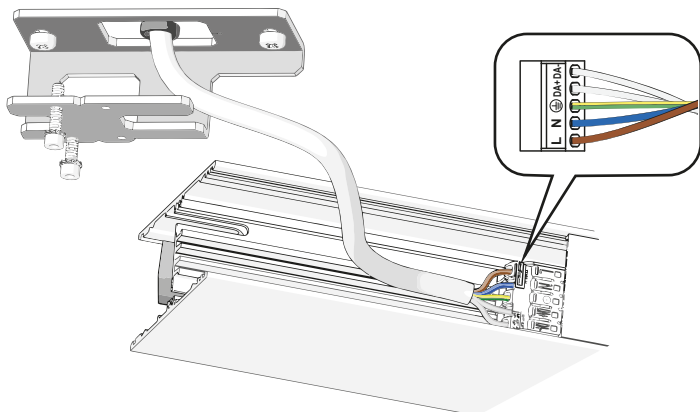

4b

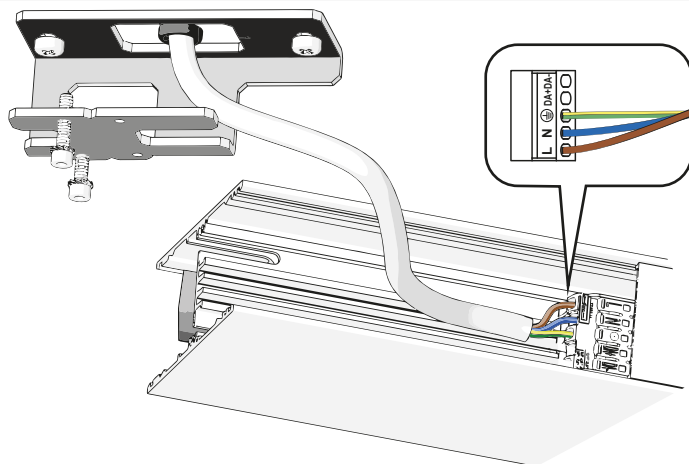

5a

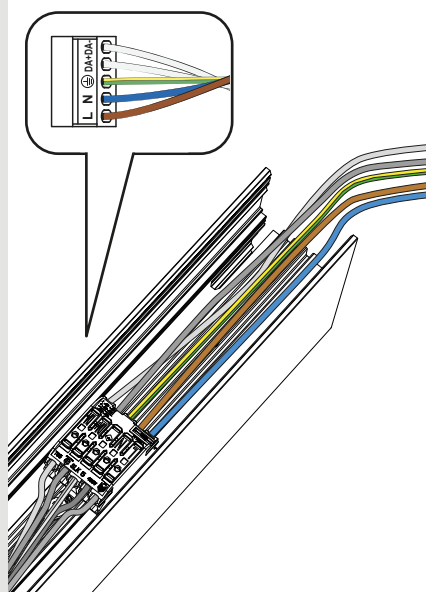

5b

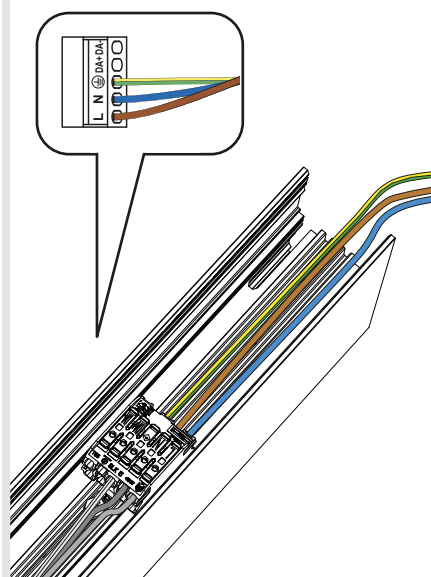



i

1

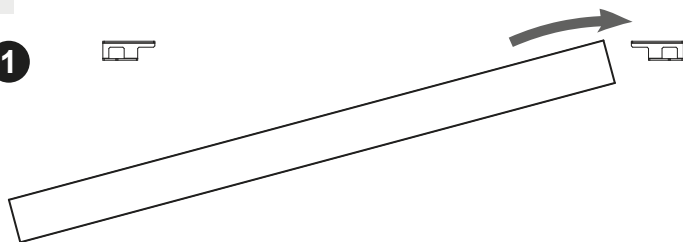

2



3



6

1

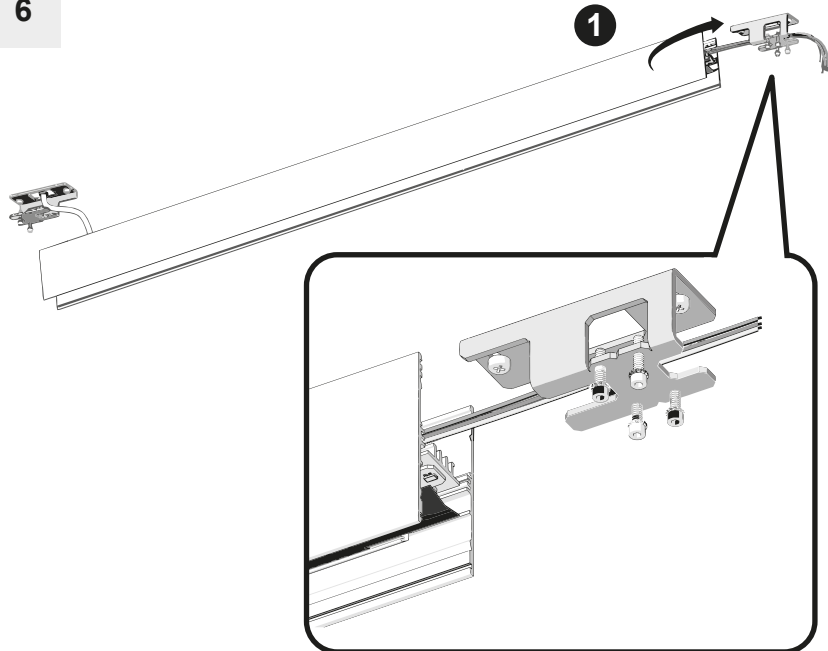

7

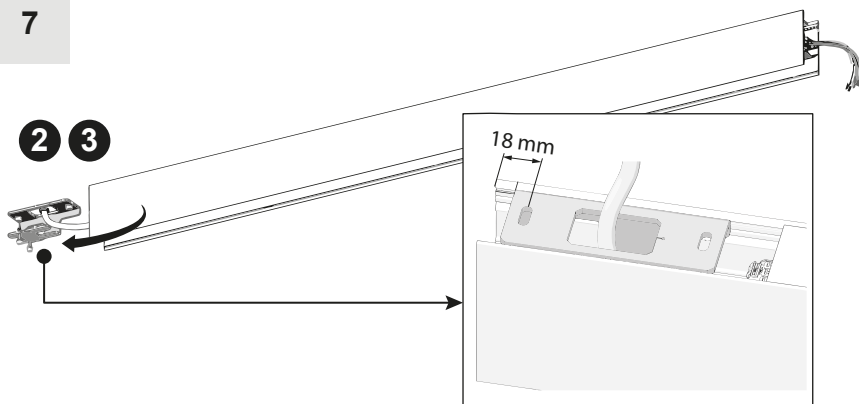

8

**DIFFUSED EMISSION**

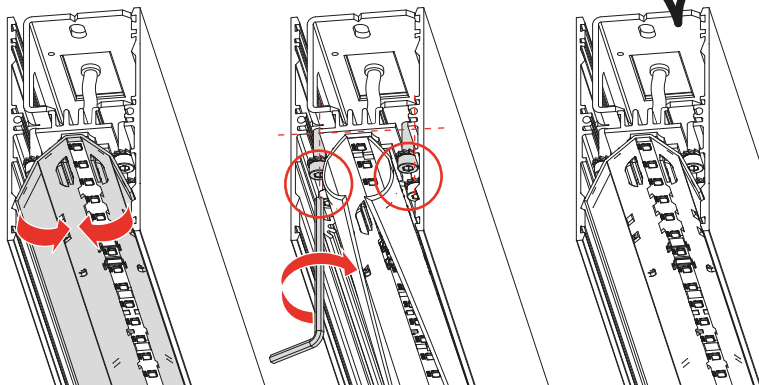

8

**CONTROLLED EMISSION**

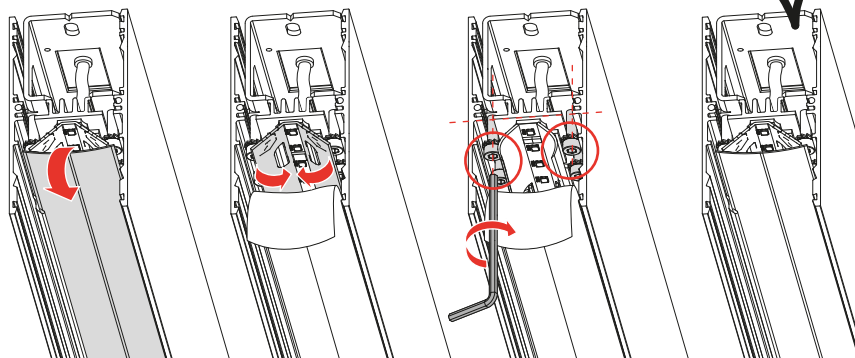

9

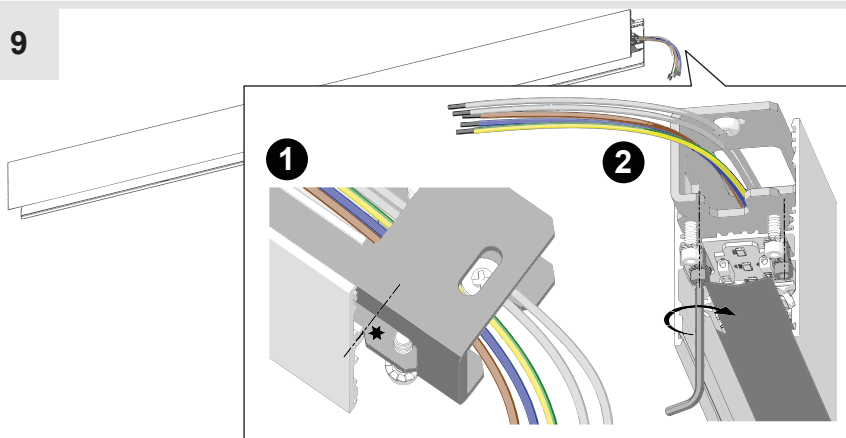

10

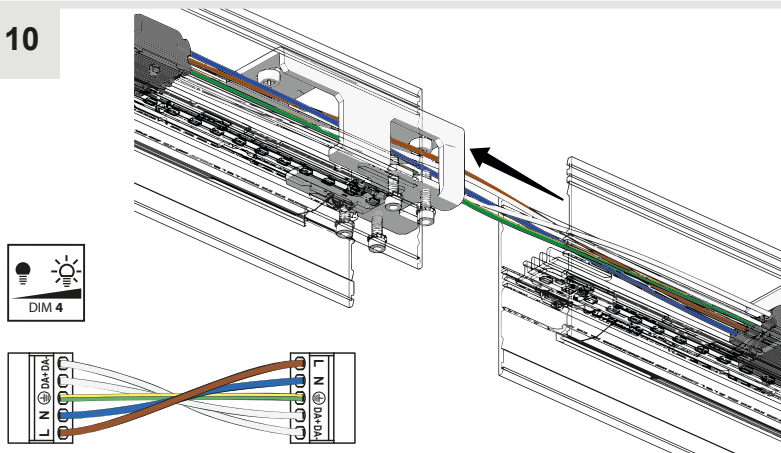

11

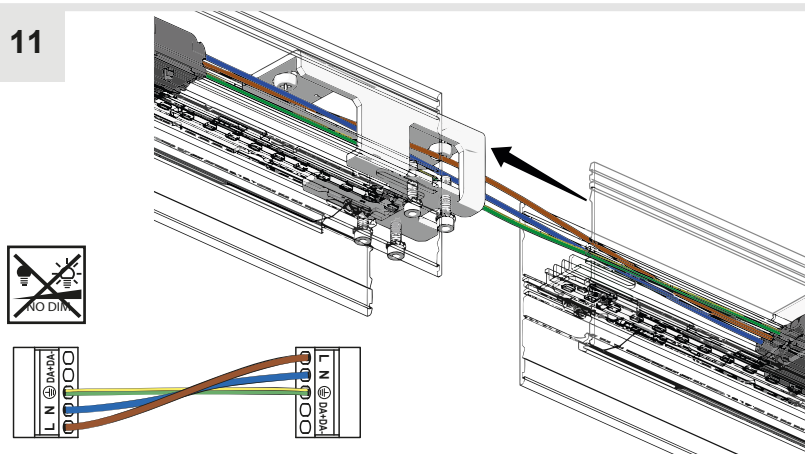

12

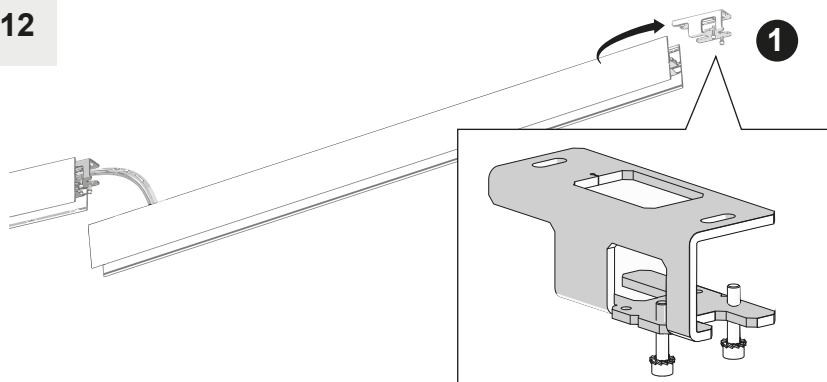

13

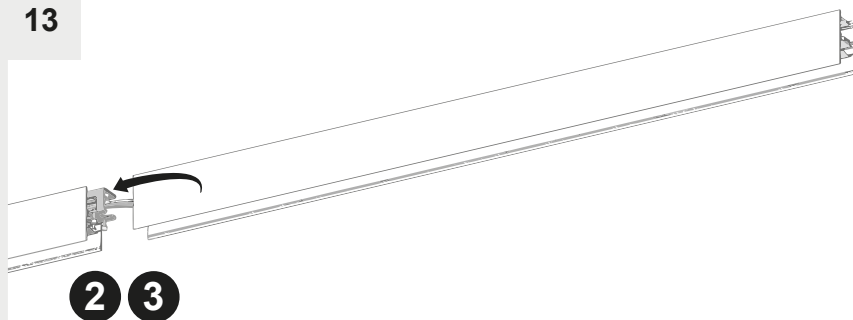

14

DIFFUSED EMISSION

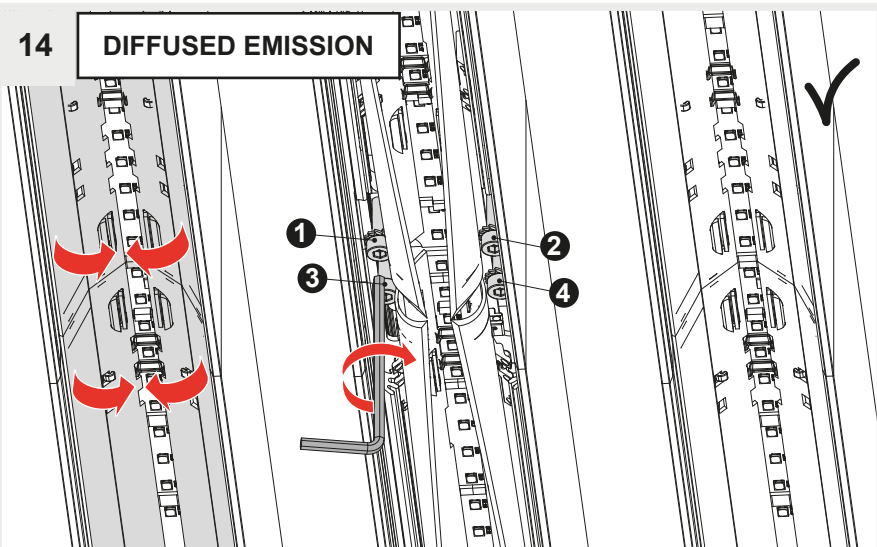

14

## CONTROLLED EMISSION

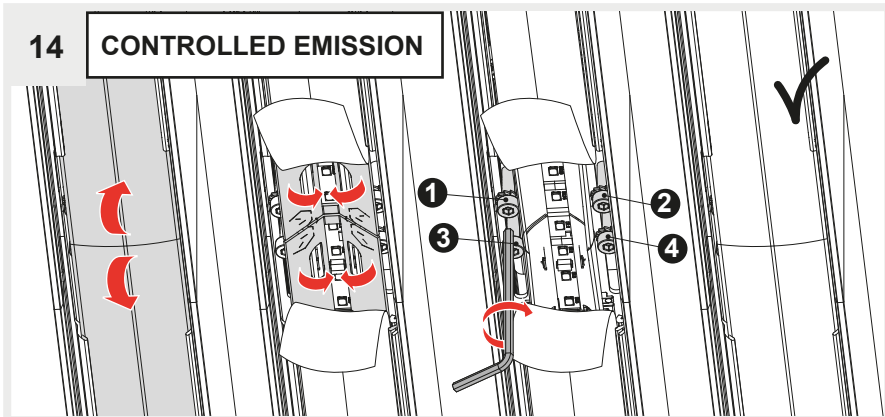

15

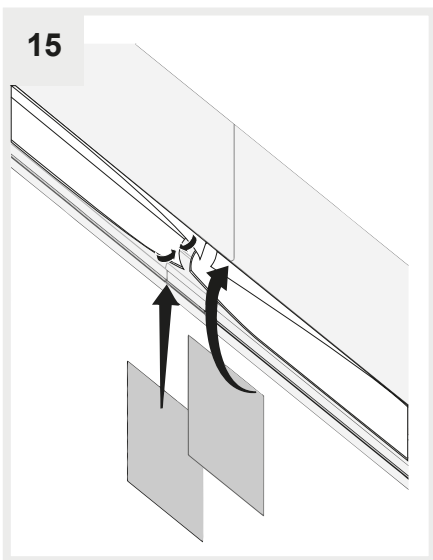

16

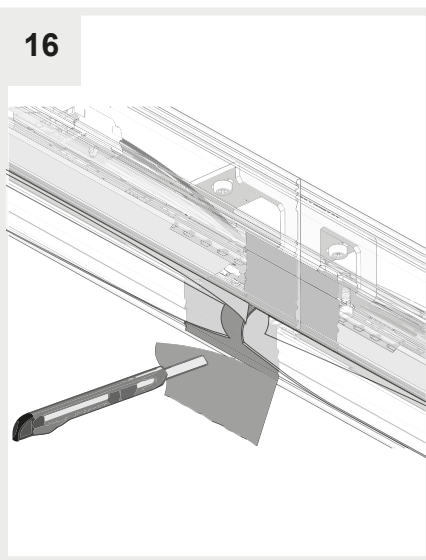

17

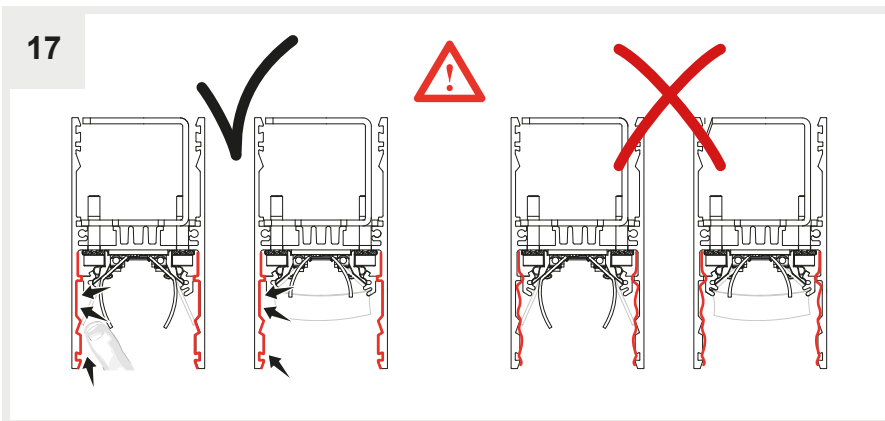

18

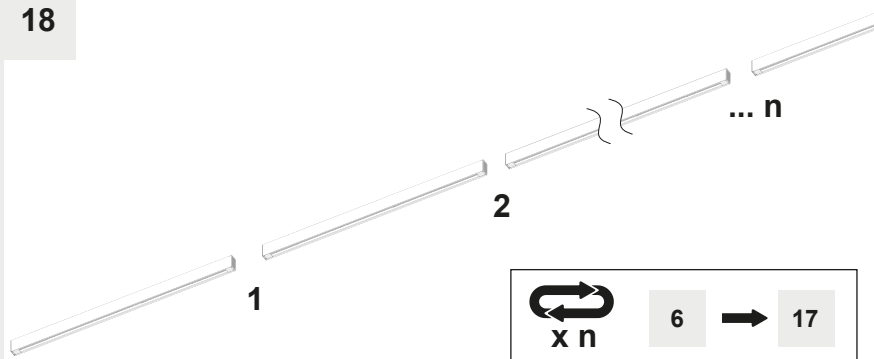

19

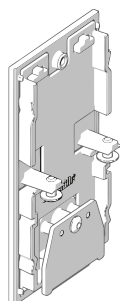
**DIFFUSED EMISSION**

L Tot [mm]	Type	L1 [mm]
$1.184 \div 2.368$	1	10
$2.368 \div 10.000$	2	20
$10.000 \div 30.000$	3	40

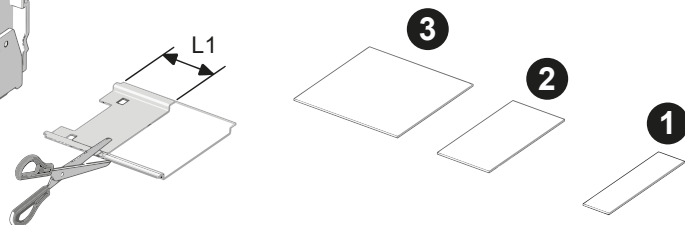
**i****DIFFUSED EMISSION**

20 → 27

**CONTROLLED EMISSION**

28 → 29

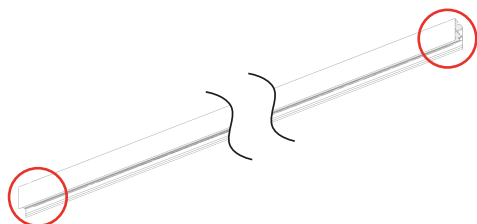

20



21



22

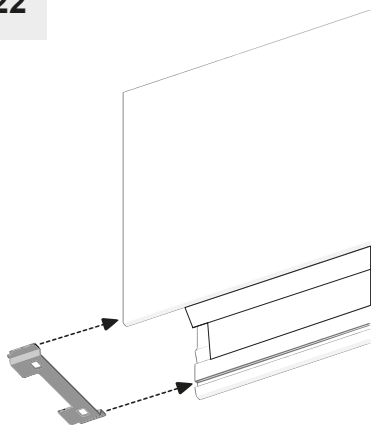

23

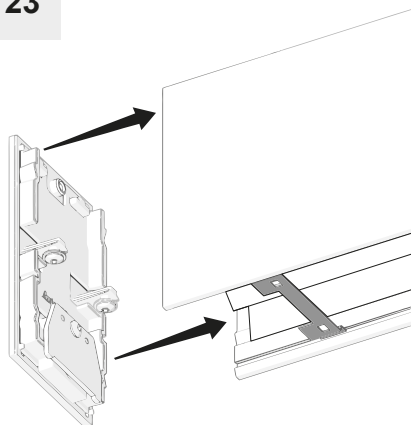

24

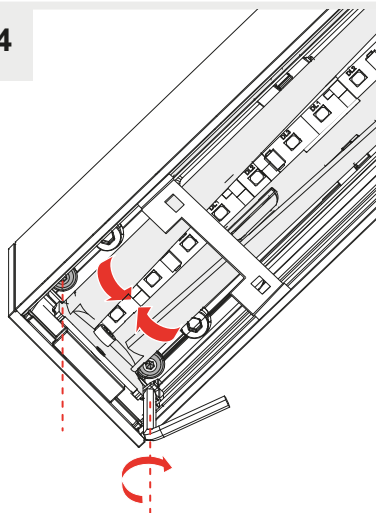

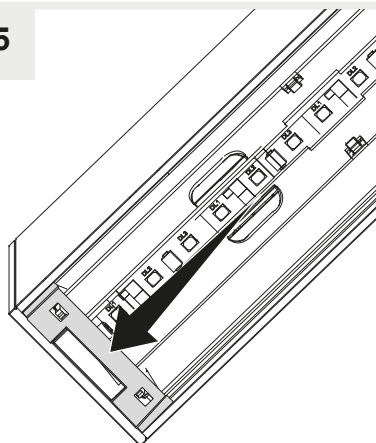

25

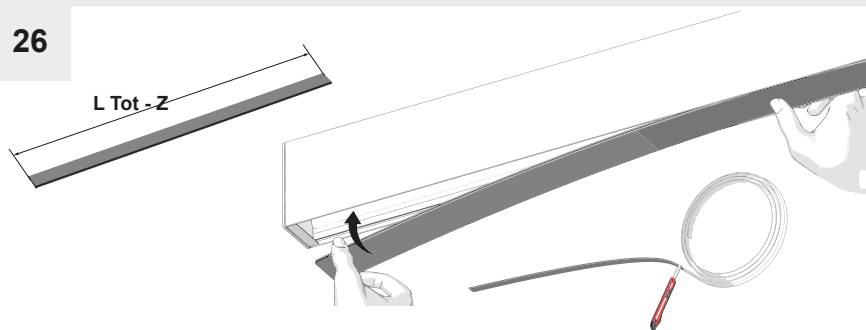

26

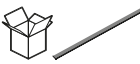

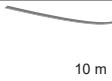
L Tot [mm]			Z [mm]
1184	1184 mm	✗	~7
1480	2368 mm	✓	~7
2368	2368 mm	✗	~7
2960	2960 [mm]	✗	~7
2960 ÷ 10000	 10 m	✓	~15
10001 ÷ 30000		✓	~35

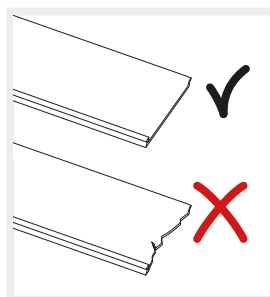
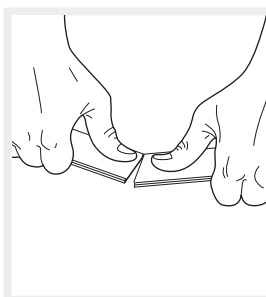
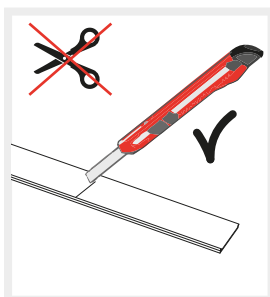

27

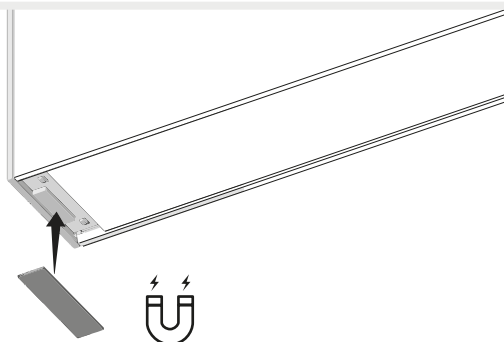



28

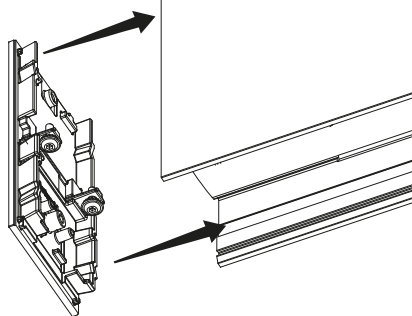

29

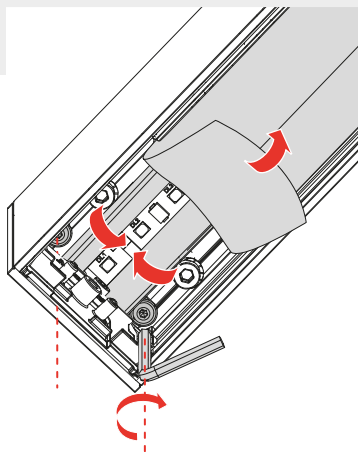

**Y503300215**

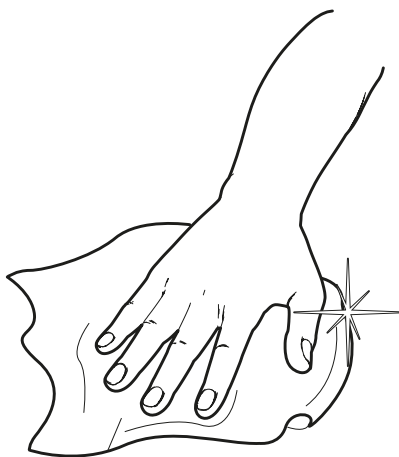
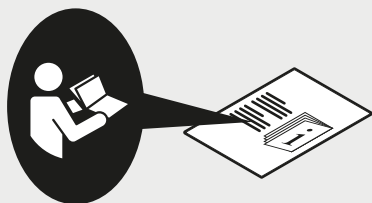





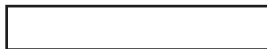

## **Artemide Spa**

via Bergamo, 18  
20006 Pregnana M.se (MI)  
ITALIA

Tel. +39 02 935 181  
Fax +39 02 935 90 254  
Fax +39 02 935 90 496

[www.artemide.com](http://www.artemide.com)

VAT IT00846890150